



FLOOR PLAN

Street Level | Exhibit Level | Ballroom & Meeting Room Level



STREET LEVEL

SOUTH BREVARD STREET

EAST MARTIN LUTHER KING JR. BOULEVARD

EAST BROOKLYN VILLAGE AVENUE

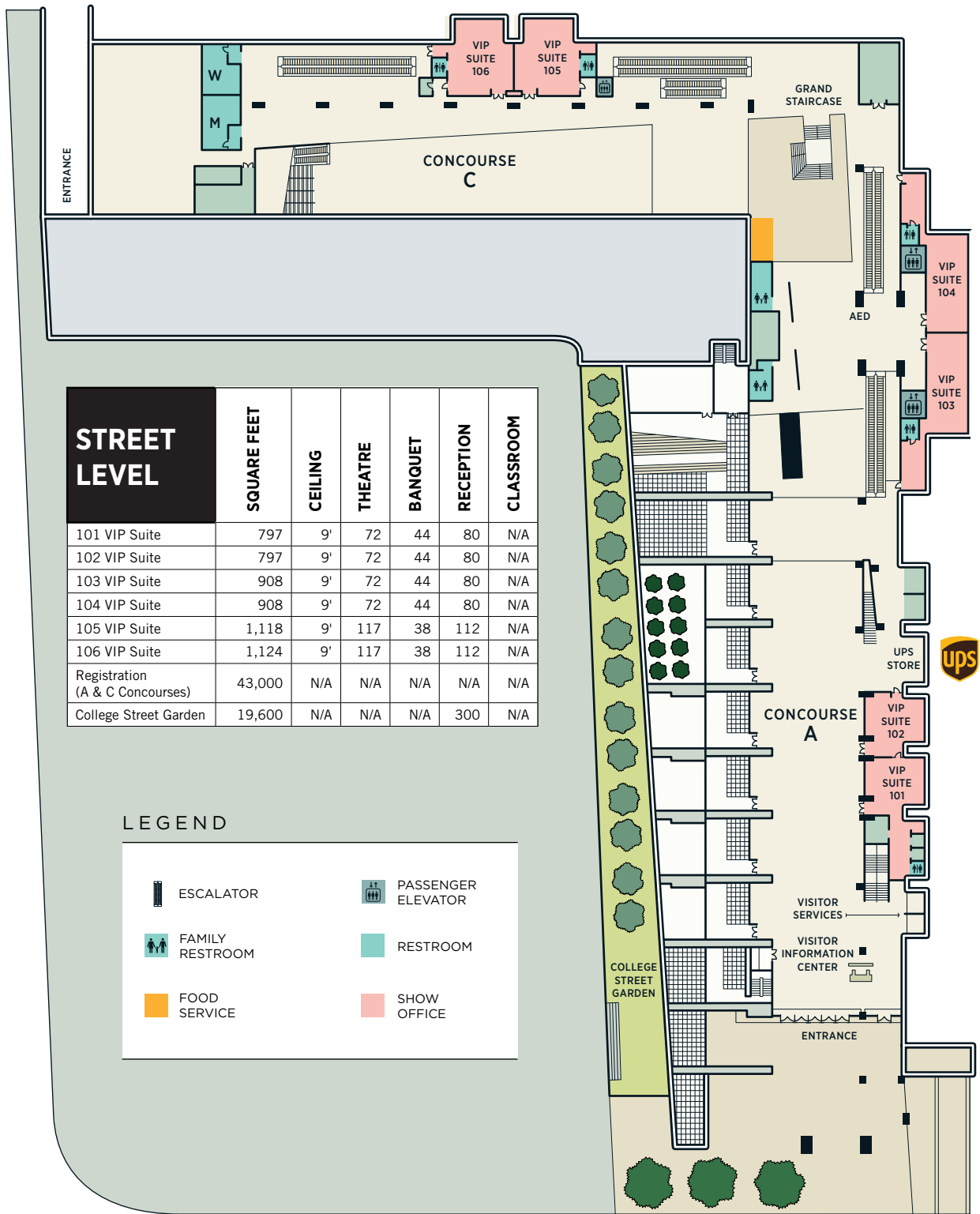

STREET LEVEL	SQUARE FEET	CEILING	THEATRE	BANQUET	RECEPTION	CLASSROOM
101 VIP Suite	797	9'	72	44	80	N/A
102 VIP Suite	797	9'	72	44	80	N/A
103 VIP Suite	908	9'	72	44	80	N/A
104 VIP Suite	908	9'	72	44	80	N/A
105 VIP Suite	1,118	9'	117	38	112	N/A
106 VIP Suite	1,124	9'	117	38	112	N/A
Registration (A & C Concourses)	43,000	N/A	N/A	N/A	N/A	N/A
College Street Garden	19,600	N/A	N/A	N/A	300	N/A

LEGEND

	ESCALATOR		PASSENGER ELEVATOR
	FAMILY RESTROOM		RESTROOM
	FOOD SERVICE		SHOW OFFICE

SOUTH COLLEGE STREET



EXHIBIT LEVEL

SOUTH BREVARD STREET

EAST MARTIN LUTHER KING JR. BOULEVARD

EAST BROOKLYN VILLAGE AVENUE



SOUTH COLLEGE STREET

EXHIBIT HALL	SQUARE FEET	CEILING	THEATRE	BANQUET	RECEPTION	CLASSROOM	BOOTH 10x10
Exhibit Hall A, B & C	280,000	30'	N/A	N/A	N/A	N/A	1,250
Hall A	100,000	30'	N/A	4,000	N/A	N/A	450
Hall B	100,000	30'	N/A	4,000	N/A	N/A	450
Hall A & B	200,000	30'	N/A	8,000	N/A	N/A	900
Hall B & C	180,000	30'	N/A	6,800	N/A	N/A	800
Hall C	80,000	30'	4,500	2,800	4,000	3,800	350
Hall C1	40,000	30'	2,000	1,400	2,400	1,900	175
Hall C2	40,000	30'	2,000	1,400	2,400	1,900	175

MEETING LEVEL

CALDWELL STREET

PG. 5

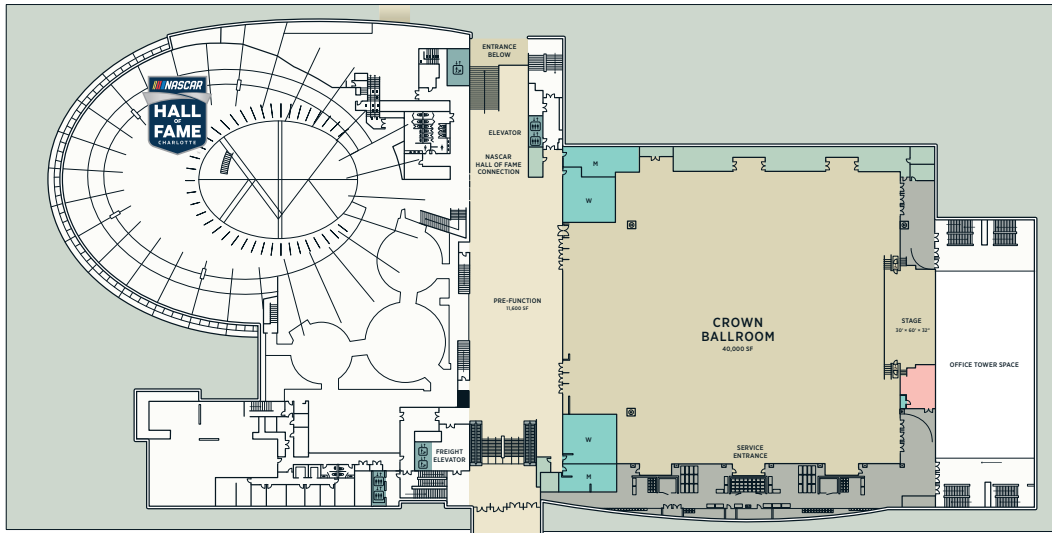

EAST BROOKLYN VILLAGE AVENUE

EAST MARTIN LUTHER KING JR. BOULEVARD

PG. 7



PG. 6

PG. 9



SOUTH COLLEGE STREET



MEETING LEVEL
CROWN BALLROOM

CALDWELL STREET



SOUTH BREVARD STREET

CROWN BALLROOM	SQ. FT.	CEILING	THEATRE	BANQUET	RECEPTION	CLASSROOM
Crown Ballroom	40,000	Tray 24' to 29'	4,000	2,000	5,200	2,400
Ballroom Pre-Function	11,600	—	n/a	n/a	800	n/a

RICHARDSON BALLROOM

SOUTH BREVARD STREET

EAST MARTIN LUTHER KING JR. BOULEVARD

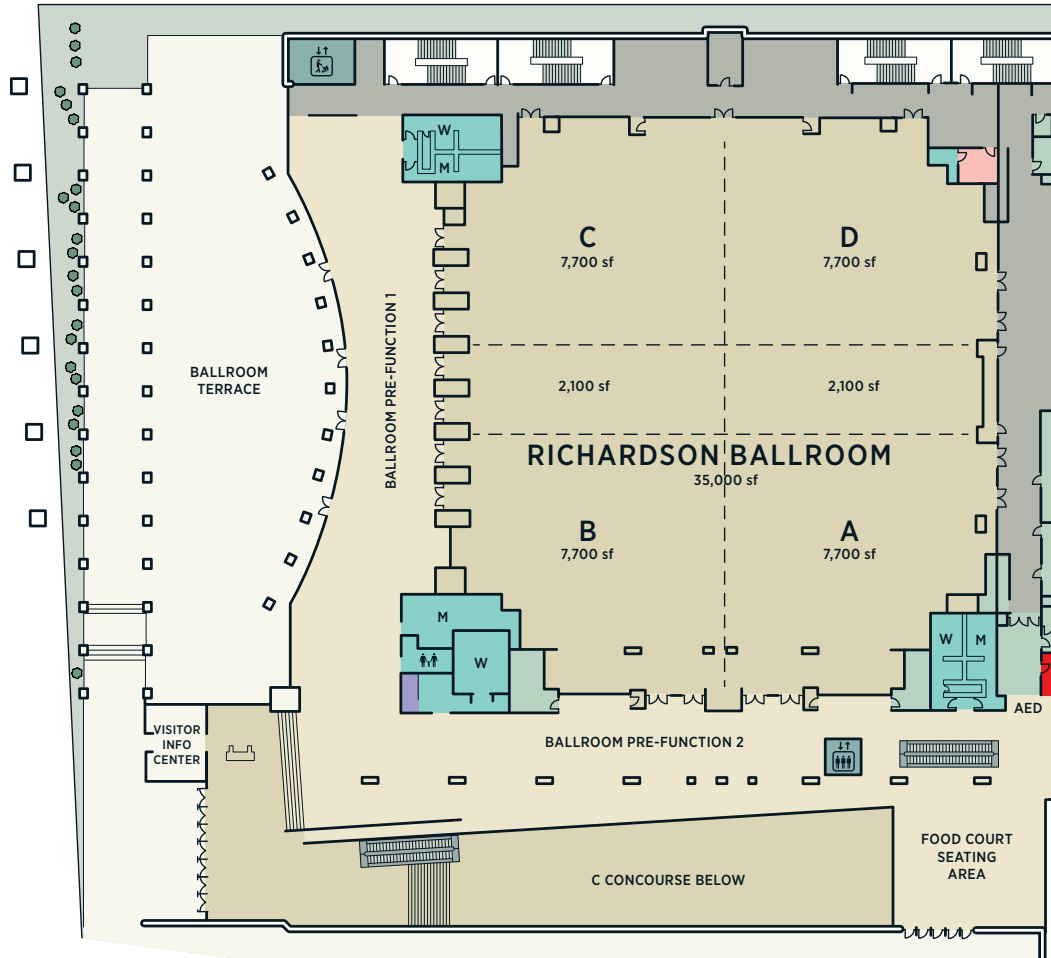

LEGEND

-  AIR WALL
-  ESCALATOR
-  FAMILY RESTROOM
-  FIRST AID
-  FREIGHT ELEVATOR
-  GREEN ROOM
-  MOTHER'S ROOM
-  PASSENGER ELEVATOR
-  RESTROOM

RICHARDSON BALLROOM	SQ. FT.	CEILING	THEATRE	BANQUET	RECEPTION	CLASSROOM
Division A, B, C & D	35,000	30'	3,500	1,500	3,500	1,748
Division A & B w/ zone	19,600	30'	1,800	1,000	2,000	980
Division A & B w/o zone	15,400	30'	1,300	680	1,500	700
Division C & D w/ zone	19,600	30'	1,800	1,000	2,000	980
Division C & D w/o zone	15,400	30'	1,300	696	1,500	700
Division A & D	17,500	30'	1,600	808	1,750	852
Division B & C	17,500	30'	1,600	824	1,750	852
Division A w/ zone	9,800	30'	900	488	975	504
Division A w/o zone	7,700	30'	600	328	770	380
Division B w/ zone	9,800	30'	900	488	975	504
Division B w/o zone	7,700	30'	600	328	770	380
Division C w/ zone	9,800	30'	1,000	488	975	504
Division C w/o zone	7,700	30'	632	328	770	380
Division D w/ zone	9,800	30'	1,000	440	975	504
Ballroom Pre-Function	15,000	30'	n/a	n/a	1,400	n/a
Ballroom Terrace	17,800	30'	n/a	n/a	900	n/a



MEETING LEVEL



EAST MEETING WING





LEGEND

-  AIR WALL

 ESCALATOR
-  FAMILY RESTROOM

 FIRST AID
-  FOOD SERVICE

 FREIGHT ELEVATOR
-  PASSENGER ELEVATOR

 RESTROOM

MEETING LEVEL

EAST MEETING WING

Room Capacities will vary based on client set-up needs.

- Capacities include minimal space for head table/staging
- Banquet set-up: 66" rounds, 8 chairs per table; 72" rounds, 10 chairs per table
- Classroom set-up: 8' x 18" tables, 4 chairs per table, 6' x 18" tables, 3 chairs per table
- W207BC, W209DE, E219BC, E220BC cannot be subdivided

EAST MEETING ROOMS	SQ. FT.	CEILING	THEATRE	BANQUET	RECEPTION	CLASSROOM
E212A	730	14'	65	24	72	36
E212B	630	14'	55	24	63	27
E212C	760	14'	50	24	75	36
E212D	630	14'	55	24	63	27
E212AB	1,360	14'	100	64	136	63
E212CD	1,390	14'	140	64	139	63
E212ABCD	2,750	14'	300	128	274	126
E213	760	12'	50	32	55	36
E214	760	12'	50	32	55	36
E215A	560	12'	40	16	40	24
E215B	480	12'	40	16	40	20
E215AB	1,040	12'	70	48	80	50
E216A	840	14'	70	24	84	40
E216B	785	14'	65	24	78	36
E216C	820	14'	70	24	81	36
E216D	785	14'	65	24	78	36
E216AB	1,625	14'	140	64	162	80
E216CD	1,605	14'	135	64	160	72
E216ABCD	3,230	14'	330	128	322	144
E217	3,050	16'	300	144	305	156
E218	2,560	16'	210	96	256	72
E219A	3,480	18'	420	144	348	160
E219BC	2,930	18'	350	144	292	160
E219D	3,480	18'	420	144	348	160
E219AB	4,940	18'	530	240	461	240
E219CD	4,940	18'	530	240	461	240
E219ABC	6,410	18'	750	336	640	305
E219BCD	6,410	18'	750	336	640	305
E219ABCD	9,890	18'	1,100	500	988	460
E220A	1,950	16'6"	168	80	195	90
E220BC	1,856	16'6"	168	80	185	90
E220D	1,858	16'6"	168	80	185	90
E220E	2,803	16'6"	243	120	280	150
E220F	2,251	16'6"	216	80	225	120
E220AB	2,890	16'6"	294	120	289	176
E220ABC	3,806	16'6"	392	200	380	264
E220ABCD	5,664	16'6"	588	280	566	384
E220ABCDE	8,467	16'6"	840	480	846	600
E220ABCDEF	10,718	16'6"	1,200	600	1,071	672
E220BCD	3,714	16'6"	392	200	371	264
E220BCDE	6,517	16'6"	702	360	651	456
E220BCDEF	8,768	16'6"	868	480	876	624
E220CD	2,773	16'6"	308	120	277	176
E220CDE	5,576	16'6"	616	280	557	384
E220CDEF	7,827	16'6"	868	440	782	552
E220DE	4,660	16'6"	518	240	466	336
E220DEF	6,911	16'6"	784	360	691	480
E220EF	5,054	16'6"	504	240	505	336
E221AB	3,118	18'6"	248	144	311	162
E221A	1,682	18'6"	162	72	168	84
E221B	1,436	18'6"	117	48	143	63
E222	2,406	18'6"	201	112	240	123



WEST MEETING WING



SOUTH COLLEGE STREET

LEGEND

- | | | | |
|-----------|------------------|--------------------|----------|
| AIR WALL | FAMILY RESTROOM | MOTHER'S ROOM | RESTROOM |
| ESCALATOR | FREIGHT ELEVATOR | PASSENGER ELEVATOR | |

MEETING LEVEL

WEST MEETING WING

Room Capacities will vary based on client set-up needs.

- Capacities include minimal space for head table/staging
- Banquet set-up: 66" rounds, 8 chairs per table; 72" rounds, 10 chairs per table
- Classroom set-up: 8' x 18" tables, 4 chairs per table, 6' x 18" tables, 3 chairs per table
- W207BC, W209DE, E219BC, E220BC cannot be subdivided

WEST MEETING ROOMS	SQ. FT.	CEILING	THEATRE	BANQUET	RECEPTION	CLASSROOM
W201A	785	14'	65	24	78	36
W201B	630	14'	55	24	63	27
W201C	785	14'	65	24	78	36
W201D	630	14'	55	24	63	27
W201AB	1,415	14'	130	64	141	63
W201CD	1,415	14'	130	64	141	63
W201ABCD	2,830	14'	300	128	283	130
W202	760	12'	50	32	55	36
W203	760	12'	50	32	55	36
W204A	560	12'	40	16	40	24
W204B	480	12'	40	16	40	20
W204AB	1,036	12'	70	48	80	50
W205A	840	14'	70	24	84	40
W205B	685	14'	65	24	78	36
W205C	820	14'	70	24	82	36
W205D	785	14'	65	24	78	36
W205AB	1,625	14'	140	64	162	80
W205CD	1,605	14'	135	64	160	72
W205ABCD	3,230	14'	330	120	322	144
W206A	2,640	16'	250	104	264	108
W206B	2,640	16'	250	104	264	108
W206AB	5,280	16'	560	240	528	250
W207A	2,050	16'	200	80	205	98
W207BC	1,980	16'	170	80	198	94
W207D	2,050	16'	200	80	205	98
W207AB	3,040	16'	360	160	304	140
W207CD	3,040	16'	360	160	304	140
W207ABC	4,030	16'	500	200	403	190
W207BCD	4,030	16'	500	200	403	190
W207ABCD	6,080	16'	780	320	607	290
W208	3,445	16'	312	160	344	132
W209A	2,189	16'6"	209	80	218	120
W209B	2,802	16'6"	364	120	280	176
W209C	1,853	16'6"	196	80	185	90
W209DE	1,855	16'6"	196	80	185	90
W209F	1,946	16'6"	196	80	194	120
W209AB	4,991	16'6"	551	240	499	352
W209ABC	6,844	16'6"	756	360	684	484
W209ABCD	7,779	16'6"	854	400	777	528
W209ABCDE	8,700	16'6"	980	440	870	616
W209ABCDEF	10,645	16'6"	1,200	560	1,064	672
W209BC	4,655	16'6"	555	240	465	304
W209BCD	5,589	16'6"	672	280	558	396
W209BCDE	6,510	16'6"	756	360	651	484
W209BCDEF	8,456	16'6"	980	440	845	616
W209CD	2,787	16'6"	330	120	278	176
W209CDE	3,708	16'6"	392	200	370	264
W209CDEF	5,654	16'6"	616	280	565	396
W209DEF	3,801	16'6"	420	200	380	264
W209EF	2,867	16'6"	330	120	286	176
W210	1,913	18'6"	187	80	191	96
W211	2,462	18'6"	207	96	246	120

